

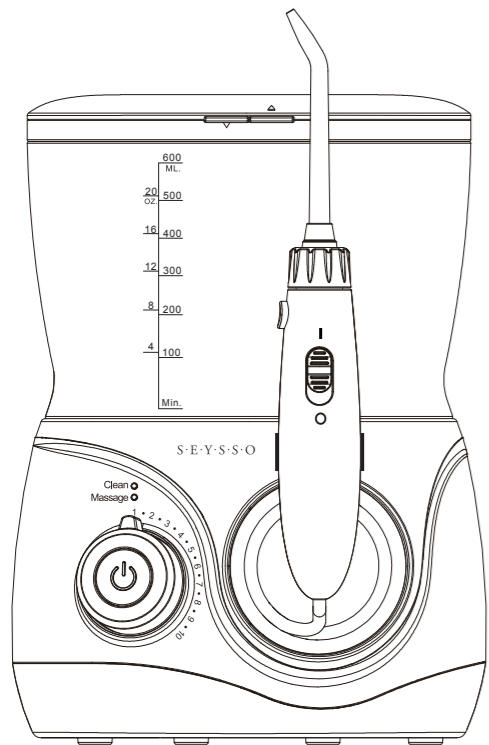

# SEYSSO Planet Water Flosser

User manual  
SPWF10



The set includes: SEYSSO Planet Water Flosser (1 pc.), charger (1 pc.), SEYSSO Planet XStandard tip (1 pc.), SEYSSO Planet XTongue tip (1 pc.), SEYSSO Planet XOrthodontic tip (1 pc.), SEYSSO Planet XPocket tip (1 pc.), user manual.

## IMPORTANT SAFEGUARDS

All information contained in this user manual is intended to instruct the user in the proper, and safe operation of this device to avoid potential injury, and damage. When using electric products, especially in the presence of children, basic safety precautions should always be followed.

READ ALL INSTRUCTIONS BEFORE USING.

## DANGER

- This device is not intended for children or persons with reduced physical, mental or cognitive abilities.
- Do not use the device if the power cord or plug is damaged, if it is not working properly, it has been damaged, or dropped into any water.
- Always unplug product after using.
- Do not touch the plug with wet hands.
- Do not place the device in, or drop into water, or other liquid.
- Do not place, or store the product where it can fall, or be pulled into a bathtub, or sink.
- Do not use the device while bathing.
- Do not use the device that has fallen into water. Unplug it immediately.

## WARNINGS

- Check the device for damage before the first use, and during the life of the product. If it is damaged, do not use it.
- Before plugging the charger into a power outlet, make sure the plug is dry.
- The device should only be used with the charger supplied.
- Children over 8 years of age, and people with reduced physical, mental or cognitive abilities should only use this product under appropriate supervision.
- Children should be supervised to ensure that they do not play with the device.
- Keep the device away from heated surfaces.
- The device is intended for indoor use only. Do not use it outdoors.
- Only use tips and accessories recommended by SEYSSO.
- Do not start irrigation without the tip in place.
- Keep the tip away from small children, as it is small enough to be swallowed, and can be lodged in the throat.
- Do not fill the container with water warmer than 40 °C. Only clean water is recommended to fill the container.
- Do not fill the container with mouthwash, as it may damage the device.
- The irrigator is designed to clean the interdental spaces, gums and tongue. Do not use it in any other way.
- Do not direct water under the tongue, into the ear, nose or other delicate areas.
- Keep the distance between the tip and your teeth and gums.
- If you experience pain or discomfort after or during irrigation, or have any concerns about the effects of the device on your health, please consult a doctor.
- If you have undergone oral surgery in the last two months, please consult a doctor.
- The device should not be disassembled.

SAVE THESE INSTRUCTIONS

## DESCRIPTION OF SEYSSO PLANET WATER FLOSSER

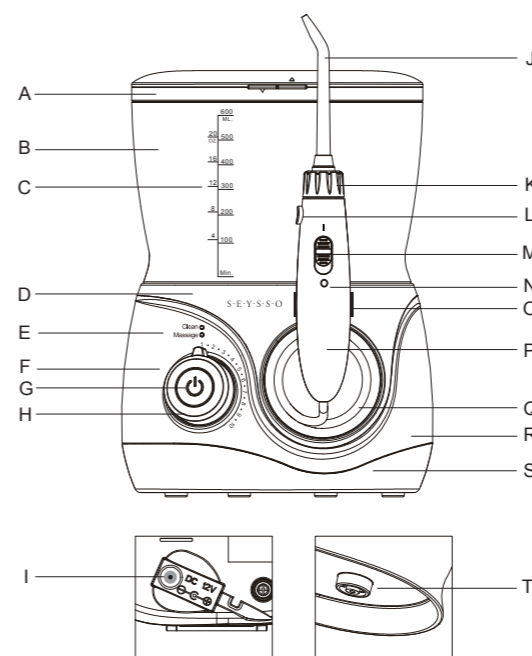

- A: Container cover with tip storage  
B: Water container  
C: Container capacity graduation  
D: Top of the irrigator base  
E: Mode indicator  
F: Water pressure scale  
G: Power On/Off, Mode button  
H: Pressure control dial  
I: DC Jack plug  
J: Tip  
K: Handle knob  
L: Tip release button  
M: Water On/Off switch  
N: Water On/Off indicator  
O: Magnetic grip of handle  
P: Handle  
Q: Hose  
R: Body of irrigator  
S: Irrigator base  
T: Container valve

## Accessories



## HOW TO USE

### FIRST STEPS

Place the device on a flat surface. Make sure that the cord and plug are dry and undamaged. (Input: 100-240V~, 50/60 Hz; Output: 12V ~, 1.5A).

1. Insert the plug into the input on the bottom of the base, and plug the cord into an electrical outlet. (Fig. 1).
2. Remove the container cover.
3. Fill the container with clean water at max. 40 °C. Place the container on the top of the device body, and press down firmly. (Fig. 2-1 i Fig. 2-2).

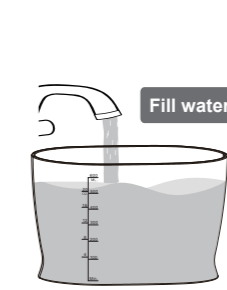
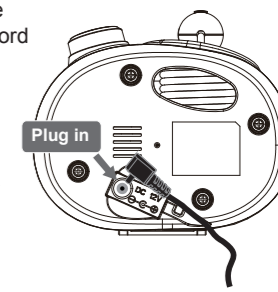

Fig. 2-1

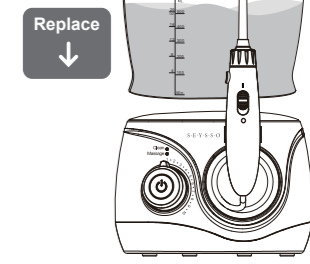

Fig. 2-2

## INSERTING AND REMOVING TIPS

### Inserting tips

Insert the tip into the center of the Water Flosser handle, pressing down firmly, until the tip clicks into place. A click indicates that the tip is properly attached. Pull the tip gently to make sure it is locked (Fig. 3)

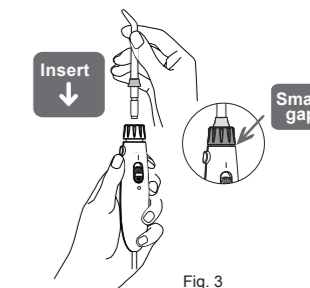

Fig. 3

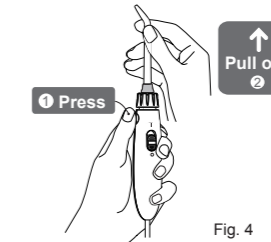

Fig. 4

**Removing tips**  
Press the release button, and pull the tip out of the handle. (Fig. 4)

## USING AN IRRIGATOR

### Attention:

Do not turn on the device before placing the tip in your mouth. For first use, set the water pressure to the lowest setting (1). Gradually increase pressure over time to the setting you prefer.

1. Make sure the water switch on the handle is set to the „0“ position. Press the button on the irrigator body to turn the device on. (Fig. 5).

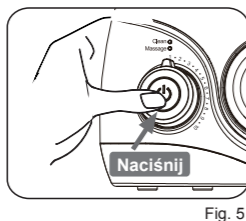

Fig. 5

Press the button again to change the mode from Clean to Massage. When using for the first time, the default mode (Clean) is recommended.

### Modes:

**Clean mode:** 2-minute cleaning program with 30 seconds intervals.

**Massage mode:** 2-minute program for cleaning your teeth and massaging your gums.

### Mode indicator:

The blue diode indicates the selected program. The cleaning mode diode is located above the massage mode diode.

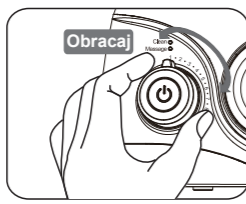

Fig. 6

2. Turn the pressure control dial on the body of device to adjust the water pressure. The pressure can be adjusted on a 10-point scale, where (1) is 2 bar and (10) is 7.6 bar. (Fig. 6)

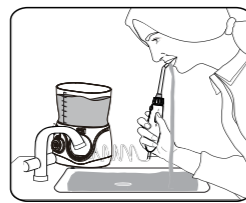

Fig. 7

3. Turn the handle knob to adjust the direction of the water stream.

4. Lean over the sink, and place the tip in your mouth. Turn the handle switch to position „I“ to start irrigation (slightly close your mouth to avoid splashing, but allow water to flow freely from mouth). (Fig. 7)

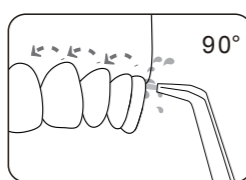

Fig. 8

5. Direct the stream at a 90-degree angle to your gumline. (Fig. 8)

6. Glide tip along gumline, and pause briefly between teeth. The device will work until the 2-minute cycle is complete or the water is switched off.

## The end of the irrigation:

### Irrigation can be terminated by using the following methods:

- 1: Automatic completion of the 2-minute cycle.
- 2: Switching off the device by using the button on the body.
- 3: In case of emergency, the power cord may be disconnected directly from electricity.

## WHEN FINISHED:

- 1: Remove the container, and pour the water out of it.
- 2: Set the water switch to position 1, and turn on the power to drain the water from the device, then switch the button back to position 0.
- 3: Turn the device off, and wipe it with a soft, dry cloth. (Fig. 9)
- 4: Press the release button, and remove the tip. Make sure the tip and the device are dry. Place the tip in container cover. (Fig. 10)
- 5: Unplug the device.

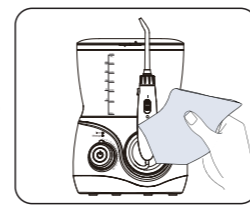

Fig. 9

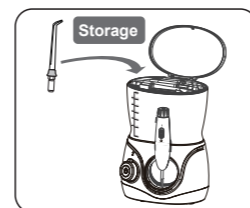

Fig. 10

**Note:** Leaving water in the device promotes the multiplication of bacteria.

## FUNCTIONS OF THE TIPS

Four tips are included with the irrigator – a standard tip for daily irrigation and three function tips.

### Tongue Cleaner Tip

To clean your tongue, place the SEYSSO Planet XTongue tip on the handle, and place the tip on the middle of your tongue, about halfway down the tongue. Set a low water pressure (1-3), and then gradually increase it as needed. Slide the tip along the tongue, towards the tip and back. A diffused stream of water will remove bacteria and food debris. (Fig. 11)

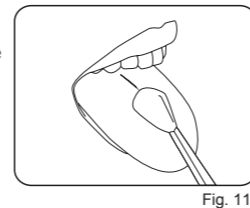

Fig. 11

### Orthodontic Tip

The SEYSSO Planet XOrthodontic tip is designed for people with fixed braces.

- 1: Place the SEYSSO Planet XOrthodontic tip on the handle.
- 2: Set a low water pressure (1-3), and then gradually increase it as needed.
- 3: Direct the water stream at a 90 degree angle to your teeth, at the gum line. Start irrigating from the last molar.
- 4: Slowly glide the tip along the gumline, stopping briefly to clean interdental spacer, and areas around braces more thoroughly.
- 5: Continue irrigating until the inside and outside of all teeth are precisely cleaned. (Fig. 12)

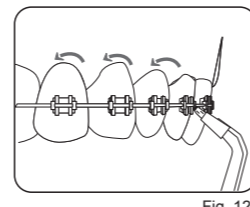

Fig. 12

### Pocket Tip

The SEYSSO Planet XPocket tip is specifically designed to clean the gingival pockets. To use the XPocket tip, ALWAYS set the device to the lowest pressure value (1-2).

- 1: Place the tip against a tooth at a 45-degree angle with the soft, rubber tip, facing the gingival pocket. (Fig. 13)
- 2: Turn on the device, and move the tip along the gumline until all gum pockets are cleaned. (Fig. 14)

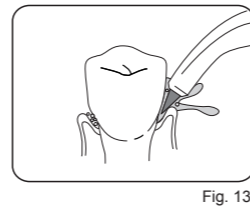

Fig. 13

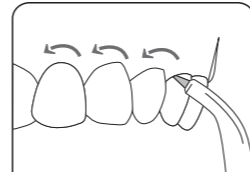

Fig. 14

### Note:

To extend the life of the tip, use it only at the lowest water pressure (1-2). Otherwise, the soft end may be damaged.

## MAINTENANCE

Use only clean water, or mild detergent to clean the irrigator. The use of acidic substances (e. g. baking soda solution, vinegar, or citric acid) can damage it.

1. The irrigator should be descaled once a month with dedicated cleaning agents.
2. Do not use the water at a temperature higher than 40°C to clean or descale the device.
3. Keep the device away from heat and direct sunlight.

### Body of irrigator

1. Remove the container, and empty it of any remaining water.
2. Clean the body with a soft cloth and liquid soap, and then dry with towel.
3. Do not immerse the body in water.

### Handle

1. Wash the handle with water, and wipe with dry towel.
2. Do not bend, pull, or twist the hose.

### Container

1. Wash the container with water, and wipe with dry towel.
2. Dry the container by placing it inverted on a flat surface.

### Tip

1. Wash with water, and wipe with a soft, dry cloth.
2. Place the tip in the container cover.
3. Replace the standard tip and tongue tip every 6 months and the other tips every 3 months.

### Charger

Wipe the metal part of the charger with dry towel every 6 months.

## PROBLEM SOLVING

Problem	Possible cause	Solution
It does not work	Silnik nie pracuje	Upewnij się, że zasilacz jest prawidłowo podłączony do gniazdzka i do urządzenia
		Upewnij się, że gniazdzko i zasilanie urządzenia są włączone
The water pressure is very low	The tip is clogged with dirt	Clean the tip, or replace it with a new one
	The tip is deformed	Replace the tip with a new one
	Container valve is dirty	Clean the valve, and fill the container with clean water
Water does not flow	The tip is clogged with dirt	Fill the container with water
	The water pressure is below the lowest level	Slide the pressure control dial to adjust the pressure
	Container valve is not open	Press down the container, or reinstall the container valve
The container is leaking	There is no valve	Make sure the valve is mounted on the container
	The valve is not mounted correctly	Remove the valve and, reinstall it
The end of the gingival pocket tip is damaged	The tip is used	Replace the tip with a new one, use only at low pressure setting (1-2)

## DISPOSAL

Only disassemble the device when disposing of it. Doing this before will destroy the product. The device must be disconnected from the power supply during disassembly.

### Specification of the device:

Product name .....SEYSSO Planet Water Flosser  
Input .....AC100V-240V 50/60HZ  
Rated Voltage .....12V  
Power .....≤15W  
On/Off switch .....Button  
Display .....LED  
Displayed information .....Clean & massage modes  
Maximum water pressure.....110PSI (7.6Bar)  
Pulses per minute.....1400  
Water tank volume .....600 ml  
Power cord length .....1.8 m  
Hose length.....1 m  
Water tightness .....IPX4

## WARRANTY AND SERVICES

SEYSSO Planet water flosser is covered by a warranty for the period of two years from the date of purchase.

**The warranty for the product is provided by WM Brands Sp. z o.o with its registered office at Dziupli 12, 02-454 Warsaw. The warranty is valid in the countries where the product has been sold by WM Brands Sp. z o. o. or an authorised distributor.**

The warranty covers damage caused by manufacturing defects or faulty manufacturing of the product. The warranty covers elements affecting the operation of the irrigator. Under the warranty, the guarantor undertakes to repair or exchange the damaged element. The warranty does not exclude, restrict or suspend buyer's privileges arising from the legislation on the warrant for defects of a sold product.

### The warranty does not apply:

1. To minor damage or surface defects that do not affect correct operation of the product;
2. To damage caused by improper usage or storage of the product;
3. If the product has been dismantled or repaired by a repair facility other than that indicated by the manufacturer;
4. If the product damage is caused by unstable voltage in the mains or voltage exceeding the specified range;
5. If the user has no valid proof of purchase of the product;
6. If the warranty period for the product has expired.

For complaints, please contact:  
**reklamacje@seyssso.com**

WM BRANDS Sp. z o.o.  
ul. Dziupli 12,  
02-454 Warsaw, Poland



Made in P.R.C.